

## C2355E HYPERCELL

HPL 4.3-10 female connector

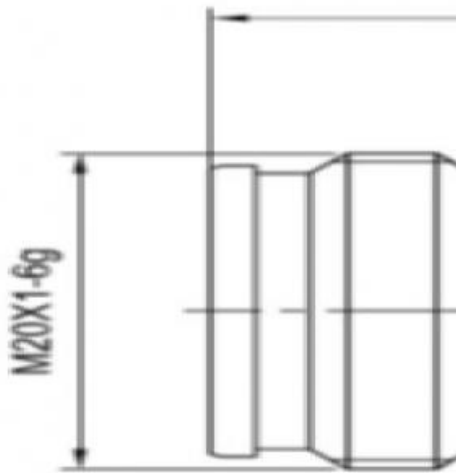

### GENERAL CHARACTERISTICS

Inner Conductor:	Silver - plated bronze
Dielectric:	PTFE
Body:	Copper alloy - plated brass
Clamping and Coupling Nut:	Nickel - plated brass
Clamping Nut Waterproof:	Silicone O-ring

### MECHANICAL & ENVIRONMENTAL

Interface Durability:	>100 cycles	
Temperature:	Operating	-40°C / +85°C
	Installation	-25°C / +55°C
	Storage	-50°C / +85°C
Weight:	94.3 g	
Waterproof Index:	IP68	
RoHS Compliance:	Yes	

## ELECTRICAL

Impedance:	50 ± 1 Ω
Operating Frequency Band:	DC ~ 4GHz
VSWR:	DC ~ 3 GHz: ≤ 1.10
	3 ~ 4 GHz: ≤ 1.20
3rd Order Passive Intermodulation, Measured In Swept Frequency Mode with 2x20W carriers, F ≤ 1880 MHz:	≤ -160 dBc
Voltage Test (at sea level):	2000 V eff / 50 Hz
Operating Voltage (at sea level):	1300 V eff / 50 Hz
Insulation Resistance:	≥ 5000 MΩ
Contact Resistance:	Inner contact: ≤ 1.0 mΩ
	Outer contact: ≤ 1.0 mΩ

## RANGE

Compatibility with ACOME HPL 50 -1/2F

M1473, M2831, M5445, M5454, M5453, M5398, M5644, M5646

Test Methods: IEC 61169-54, IEC 62037-3, IEC 60529

## RECOMMENDATIONS

### INSTALLATION INSTRUCTION

ANM - C2355E